

Ac/24084/03

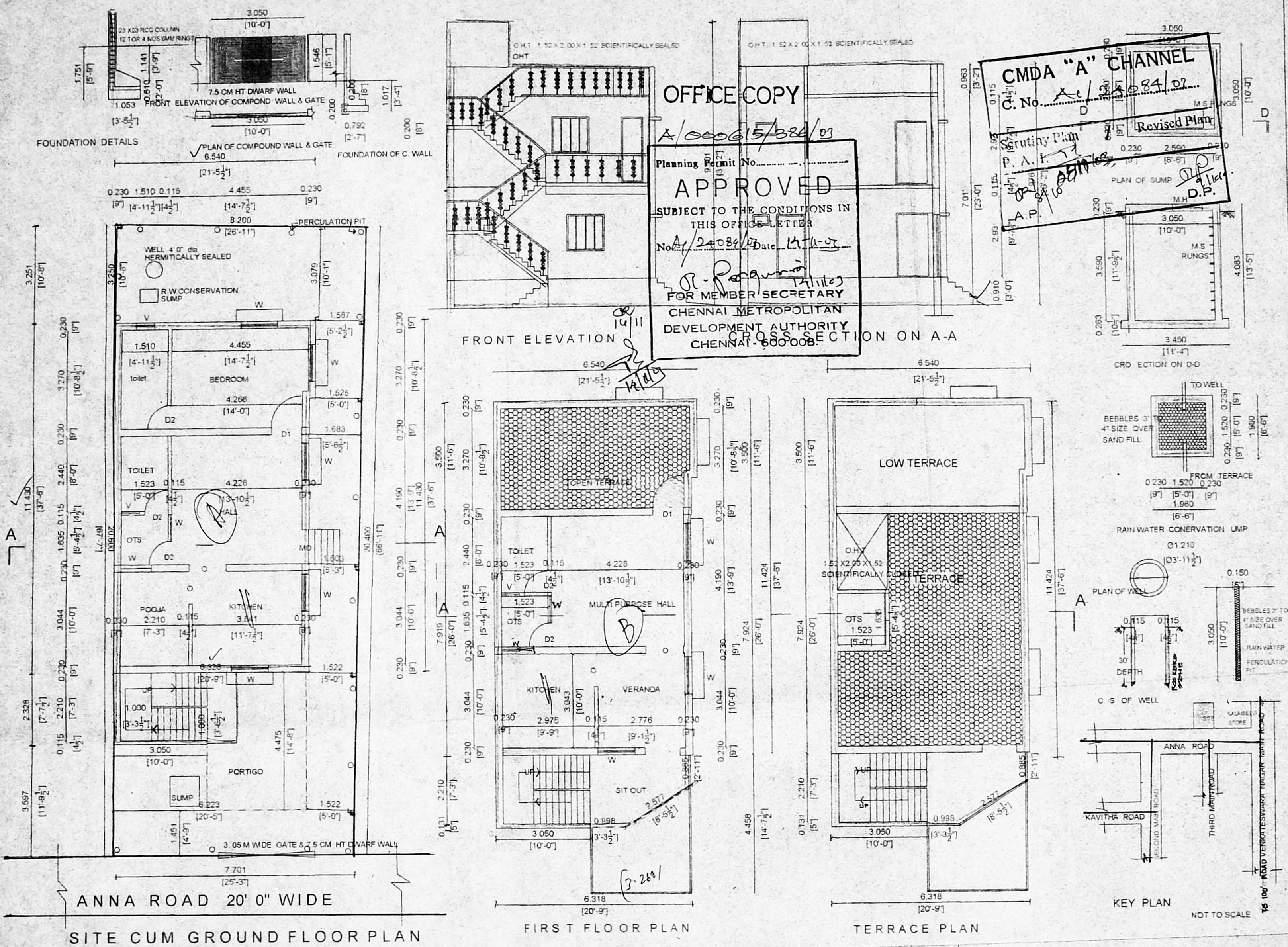

OFFICE COPY

A/000615/384/03

Planning Permit No. _____

APPROVED

SUBJECT TO THE CONDITIONS IN THIS OFFICE LETTER

No. A/24084/03 Date 17-11-03

R. Parvathi

FOR MEMBER SECRETARY
CHENNAI METROPOLITAN DEVELOPMENT AUTHORITY
CHENNAI - 600 008

CMDA "A" CHANNEL

C. No. A/24084/03

Revised Plan

Scrutiny Plan

P. A. I. /

A.P.

PLAN OF SUMP

CROSS SECTION ON D-D

SPECIFICATION

R.C.C. 1:2:4 COLUMN BEAMS ROOF SLAB LINTELS
P.C.C. 1:4:8 SUB-BASE FLOORING, FDN CONC
BRICK WALL 1 IN CM 1:5 OVER RENDERING IN CM 1:4
SECOND CLASS HARD WOOD FOR JOINERIES
MOSAIC FLOORING, H.P. TILES OVER TERRACE

COLOUR INDEX

PROPOSAL	ROAD	BOUNDARY

JOINERY DETAILS

D	DOOR	1.20 X 2.10
D1	DOOR	0.90 X 2.10
D2	DOOR	0.75 X 2.10
W	WINDOW	1.20 X 1.20
V	VENTILATOR	0.45 X 0.60

AREA STATEMENT

	SQM	SC.FT
PLOT EXTENT	163.04	1755.00
PROG F	72.81	783.73
PROF F	45.24	486.97
TOTAL	118.05	1270.70
COVERAGE	44.65%	
F.S.I	0.72	

PLAN SHOWING THE PROPOSED CONSTRUCTION OF RESIDENTIAL BUILDING AT PLOT NO O.S.NO 117, NEW TS. NO 68 / 20, BLOCK NO 13 OF ARUMBAKKAM VILLAGE. ANNA STREET, VENKATAKRISHNA NAGAR ARUMBAKKAM, CHENNAI 600 106 PATTA NO 569 /02 CORPORATION DIVISION NO 75 ZONE 5 FOR Mrs VANNAMMA

A. Vannamma

owners signature

S. SUNDARAM, L.C.E.,
Licensed Surveyor Class-II N. 27/2002-2003
Corporation of Chennai

PLOT NO. 4, T. 1, 3, 4, E. ANNANDAR, KARAVANGA, PUZZA, CHENNAI - 600 003



SCALE 1:100 / 1" = 8'0"

NOT TO SCALE